

Precast concrete I column.



Building: 5 BroadGate  
architect: Make  
Contractor: Mace  
Structural Engineer: Burro Happold  
Site visit Nov 27 with Anya

From my understanding most of the components at 5 broad gate are constructed of site then delivered. This includes the pre cast collums which are manufactured by industrial methods based on mass production in order to build a large number of buildings in a short time at low cost.

Materials of precast collum

Concrete mix with iner steel framework. casted of site. Concrete mix of 1 x cement, 2x fine and 2 x course aggregates

Dimension of beams are 2.7 meters in height and 400cm in width.

Inner beams will be framed and not exposed to enviornmental eliments.

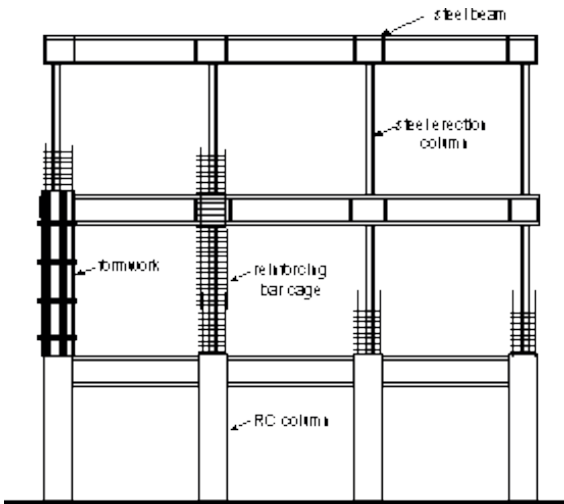

A pre cast concert column is designed to carry compressive loads. It is made from concrete with an embedded steel frame to provide reinforcement

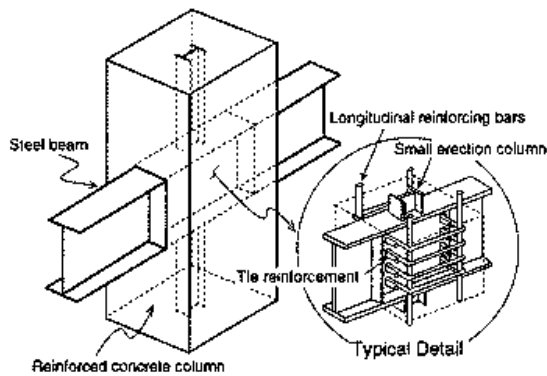

joint is constructed between the reinforced concrete collum and steel beam using tie reinforcement. as shown in diagram.

