

# SUMMER HOUSE, JUDITH BENZER ARCHITEKTUR, AUSTRIA

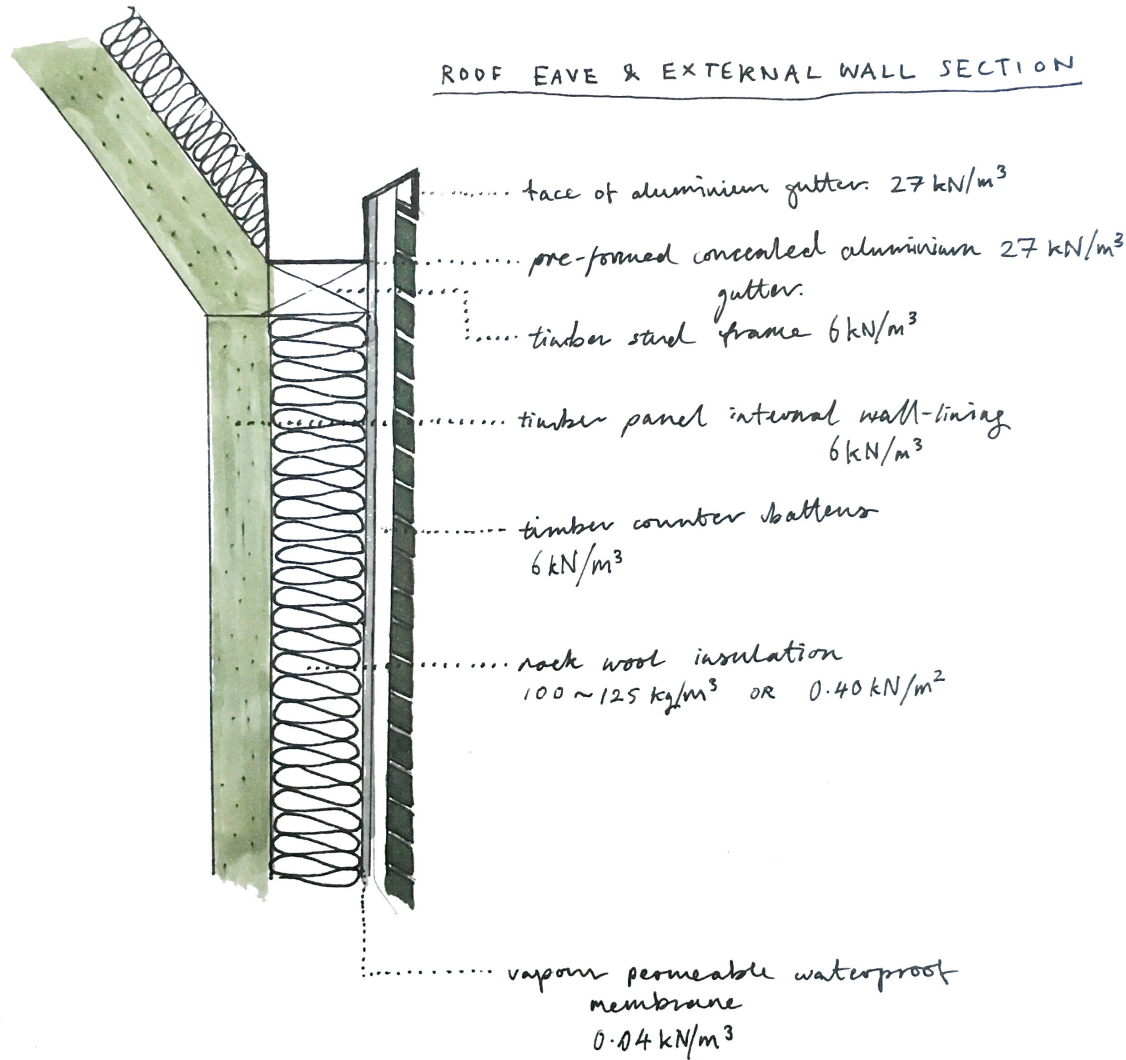

The facade of this simple house features larch cladding attached to timber counter battens to create a spaced timber surface. Behind this is a waterproof membrane and insulation. The vertical wall is topped by a concealed aluminium gutter which collects water on the inside of the roof eave.

